

Wireless Touch Sensor
BlueLED Mouse
M-TC01DB series
User's Manual

Thank you for purchasing ELECOM's Wireless Touch Sensor BlueLED Mouse "M-TC01DB" Series. This user's manual explains how to properly and safely use the M-TC01DB Series mouse. Please read this manual before use and keep it in a safe place where it can be accessed whenever it is needed.

* Except in certain cases, the M-TC01DB Series is referred to as "this product" in this manual.

Safety Precautions

■Meaning of symbols

| | | |
|--|----------------|--|
| | WARNING | Failure to observe precautions may result in serious personal injury or death due to fire, electric shock, or other causes. |
| | CAUTION | Failure to observe precautions may result in damage to other equipment or personal injury due to electric shock or other causes. |

- Prohibited action
- Mandatory action
- Situation that needs attention
- Notes and reference information

Observe these precautions carefully to avoid personal injury, damage, fire, and other problems.

| | | |
|--|----------------|--|
| | WARNING | <p> If a foreign object (water, metal chip, etc.) enters the product, immediately stop using the product and disconnect the receiver unit from the PC, and remove the battery from the mouse. If you continue to use the product under these conditions, it may cause a fire or electric shock.</p> <p> If this product is generating heat, smoking, or releasing an odour, stop its use immediately and shut down your PC. After making sure that the product is not too hot to inflict burns, remove the receiver unit from the PC and take the batteries out of the mouse. After doing this, contact the retailer from whom you purchased the product. Do not continue use as there is a risk of fire or electric shock.</p> <p> Do not drop or hit this product. If this product is damaged, immediately stop using the product and disconnect the receiver unit from the PC, and remove the battery from the mouse. After doing this, contact the retailer from whom you purchased the product. If you continue to use the product in a damaged condition, it may cause a fire or electric shock.</p> |
|--|----------------|--|

| | | |
|--|----------------|---|
| | WARNING | <p> Avoid looking directly at the light of the sensor as doing so may cause eye damage.</p> <p> Do not attempt to disassemble, modify or repair this product by yourself, as this may cause a fire, electric shock or product damage.</p> <p> Do not put this product in fire, as the product may burst, resulting in a fire or injury.</p> <p> Do not connect or disconnect the receiver unit with a wet hand, modify the receiver unit or bend it forcibly, as this may cause a fire or electric shock.</p> <p> Always keep the receiver unit out of the reach of children as there is a danger that they may swallow it.</p> |
|--|----------------|---|

| | | |
|--|----------------|---|
| | CAUTION | <p> Do not place this product in any of the following environments:</p> <ul style="list-style-type: none">• In a car exposed to sunlight, a place exposed to direct sunlight, or a place that becomes hot (around a heater, etc.)• In a moist place or a place where condensation may occur• In an uneven place or a place exposed to vibration• In a place where a magnetic field is generated (near a magnet, etc.)• In a dusty place <p> This product does not have a waterproof structure. Use and store this product in a place where the product body will not be splashed with water or other liquid. Rain, water mist, juice, coffee, steam or sweat may also cause product damage.</p> |
|--|----------------|---|

- Do not use this product with any device that may significantly affect other equipment in the event that it malfunctions.
- If this product is used on a transparent surface such as glass or a highly reflective surface such as a mirror, the optical sensor will not function correctly and mouse cursor movement will become unstable.
- When not using the mouse for one month or more, disconnect the receiver unit from the PC.
- When you no longer need to use this product and the battery, be sure to dispose of it in accordance with the local ordinances and laws of your area.

■Batteries

| | | |
|--|----------------|--|
| | CAUTION | <p> Use AA alkaline batteries, AA manganese batteries, or AA nickel hydride rechargeable batteries with this product.</p> <p> If this product will be unused for a long period of time, remove the battery to avoid battery leakage and failure.</p> |
|--|----------------|--|

■Cleaning the Mouse

If the product body becomes dirty, wipe it with a soft, dry cloth.

- Use of a volatile liquid (paint thinner, benzene, alcohol, etc.) may affect the material quality and colour of the product.

Cautions for Wireless Equipment

This product is wireless equipment using the entire range of the 2.4 GHz band and it is possible to avoid the band of mobile object identification systems. GFSK is used for the radio wave method. The interference distance is 10 m. The 2.4 GHz band is also used by medical equipment, Bluetooth®, and wireless LAN equipment conforming to the IEEE802.11b/11g/11n standard.

- Before using this product, check that there are no other "radio stations"* operating nearby.
- If electromagnetic interference occurs between this product and other "radio stations", move this product to another location or stop using this product.

* Other "radio stations" refer to industrial, scientific and medical devices using the same 2.4 GHz band as this product, other radio stations of this type, licenced radio station premises for mobile object identification system that is used in factory production lines, certain non-licenced low power radio stations and amateur radio stations.

- Do not use this product with a device that may have a serious function or influence. There are rare cases where an external radio wave at the same frequency or the radio wave emitted from a mobile phone causes this product to malfunction, slow down, or fail to operate.
 - Do not use this product in a hospital or other locations where the use of radio waves is prohibited. The radio waves of this product may affect electronic and medical devices (e.g. pacemaker).
 - The use of a wireless mouse in an aircraft is prohibited by aviation law because doing so may interfere with flight safety. Turn off the power of the mouse body before boarding an aircraft and do not use it in the aircraft.
- * ELECOM is not liable for any accident or social damages incurred by the failure of this product.

Package Contents

This product's packaging contains the items listed below. Before using the product, check that all items are present. We make every effort to ensure that all products are packaged correctly. However, in the event that an item is missing or damaged, contact the retailer from whom you purchased the product.

- Mouse x1
- Receiver unit x1
- AA alkaline dry battery (for checking operation) x2
- User's Manual (this manual) x1

Part Names

■Mouse

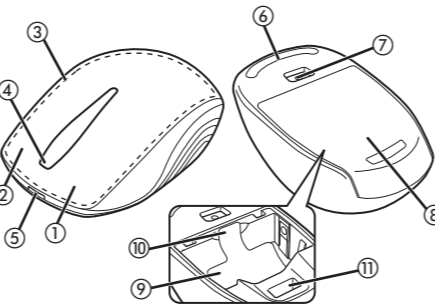

■Receiver unit

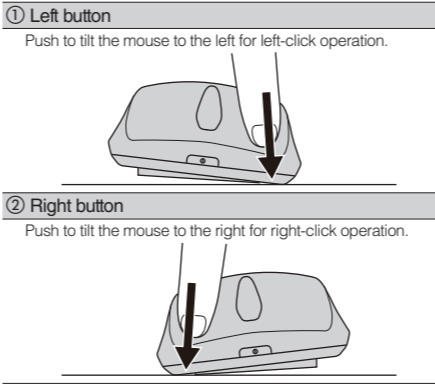
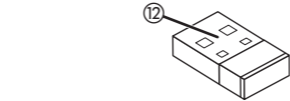

- ③ Touch sensor**
Use the touch sensor for touch and slide motions with your fingertips.
 For details on touch operation, refer to "Using the Touch Operation" (See reverse).
- ④ Power indicator**
When the power turns on, the power indicator lights up in green for 2 seconds.
- ⑤ Power switch**
When the power is off, hold the power switch down for 3 seconds to turn the mouse on. When the power is on, hold it down for 3 seconds to turn the mouse off.
- ⑥ Click switch**
Tilt the mouse to left-click or right-click using this switch.
- ⑦ Optical sensor**
Illuminates blue when the mouse body is turned on. When the mouse body is moved, this sensor detects mouse movement.
- ⑧ Battery cover**
This cover is removed to install batteries.
- ⑨ Battery housing**
Batteries are inserted here.
- ⑩ Battery removal sheet**
Used to remove the batteries from the battery housing.
- ⑪ Receiver unit housing**
Used to store the receiver unit.
- ⑫ USB connector (male)**
Connected to a PC USB port.

Preparation before Use

Installing/Replacing the Battery

Before using this product, install two AA batteries in the mouse body.

- 1 Remove the battery cover.**
- 2 Insert the battery.**

Make sure that the polarity is correct.
- 3 Install the battery cover.**

■Replacing batteries

- 1 Remove the battery cover.**
- 2 Remove the battery by using the battery removal sheet.**
- 3 Insert the battery.**

Do not mix different types of batteries or use old batteries with new batteries to avoid battery leakage and failure.
- 4 Install the battery cover.**

Turning On and Off the Mouse

■Turning on the mouse

When using this product, turn the mouse body power on. Press and hold the power switch for 3 seconds. The power indicator lights up green for 2 seconds.

■Turning off the mouse

When not using the mouse, turn it off to save battery power. To turn off the mouse, press and hold the power switch for 3 seconds when the power is on. The power indicator lights up orange and turns off in 2 seconds.

■Restoring from sleep state

Touch the touch sensor.
 To reduce battery drain, the mouse enters sleep mode automatically if it is left without being operated for a certain period of time with the power or switch turned on.

Inserting and Taking Out the Receiver Unit

■Inserting the receiver unit

- 1 Remove the battery cover.**
- 2 Place the receiver unit into the receiver unit housing.**
- 3 Install the battery cover.**

■Taking out the receiver unit

- 1 Remove the battery cover.**
- 2 Take the receiver unit out of the receiver unit housing.**
- 3 Install the battery cover.**

When using Windows®

Step1 Check USB ports

Check the USB port on your computer.

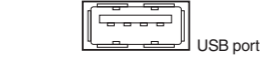

- Any USB port may be used.
- This product can be connected to a USB hub. However, it may not work depending on the power supply capability of the USB hub.

Step2 Installing the Receiver Unit

- 1 Activate the PC**
 - If Windows® prompts you to choose an account (a user name) when it starts up, be sure to log on using an administrator account.
 - Wait until Windows® has started up completely.
- 2 Insert the receiver unit into the USB port of the PC.**

Carefully check the orientation of the connector and the place where you will connect the receiver unit.

 - If you feel strong resistance when inserting the receiver unit, check that the shape and orientation of the connector is correct. Using excessive force may damage the connector and cause injury.
- 3 The mouse driver is installed automatically.**

Step3 Checking operation

Check that the mouse scrolls up and down correctly in Windows® Internet Explorer.

- 1 Click on [Internet Explorer®] on the desktop.**
Internet Explorer® will launch.
- 2 Display your favourite web site in Internet Explorer®.**
* The sample website used here is the ELECOM homepage.



- 3 Touch the centre of the touch sensor and move your finger up or down.**

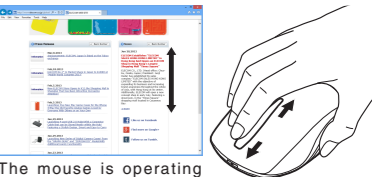

The mouse is operating normally if the screen moves up and down as you scroll the tilt wheel.

- The finger slide motion on the centre part of the touch sensor may not work with certain applications that do not support the scroll function.

Using the Touch Operation

The touch operations that can be used with this product are as follows:

Zoom In / Zoom Out

Swipe up or down the left side of the touch sensor using your finger.

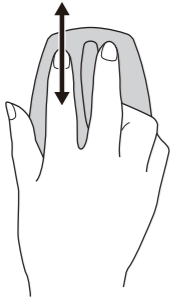

Zoom In

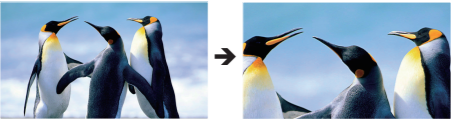

Zoom Out

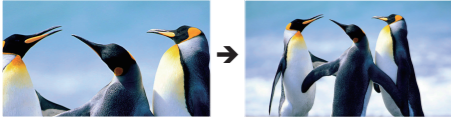

Scroll

Swipe up or down the centre part of the touch sensor using your finger.

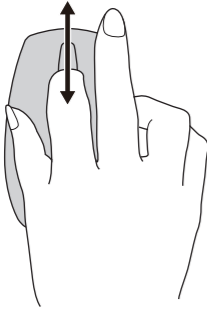

Previous Page / Next Page

Swipe up or down the right side of the touch sensor using your finger.

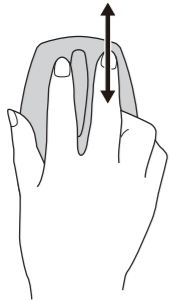

Previous Page



Next Page



Hide/Show Desktop

Swipe down the right and left parts of the touch sensor using two fingers.

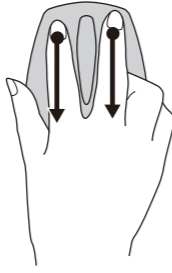

Show Charms

Swipe from right to left using your finger.

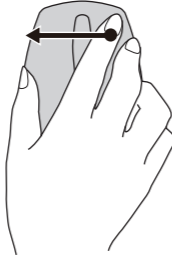

Switch Applications

Swipe from left to right using your finger.



Show Start Screen

Swipe up the right and left parts of the touch sensor using two fingers.



Troubleshooting

When the product appears to be malfunctioning

■ When the mouse pointer on the screen does not move, or moves unstably, when the mouse is moved

→ It is possible that the reflectivity of the surface on which this product is being used is not suitable for an optical mouse. Use this product on a mouse pad that is designed for use with optical mice.

→ When using this product on a metallic surface such as a steel desk, radio wave outreach may be shortened. In such cases, move the receiver unit closer to the mouse until mouse operation stabilises.

→ It is possible that the receiver unit is not connected correctly to the USB port. Disconnect the receiver unit from the USB port and reconnect it.

→ The receiver unit and the mouse body are too far apart or there is a possibility that the receiver unit is facing in a direction from which it cannot receive radio signals. Adjust the position of the receiver unit. The operable range of this product is the area within a circle with a radius of 10 m from the receiver unit. Depending on the usage environment, the mouse may not operate even when it is within approximately 10 m of the receiver unit. In such cases, move the mouse closer to the receiver unit until operation stabilises.

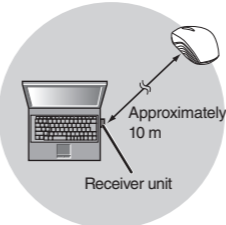

→ Interference may occur if multiple units of this product are used together or if this product is used with other wireless devices. In this case, change the channel of other wireless devices. (Multiple units of this product have an automatic channel avoidance function.)

→ Operation becomes unstable when battery power is low. See "Installing/Replacing the Battery" on the reverse of this sheet, and replace the batteries as soon as possible.

- The alkaline batteries supplied with this product are for checking product operation. These batteries may discharge and drain during storing and shipping.
- When battery level becomes low, the power indicator blinks orange.

* When not using the mouse, turn it off to save battery power.

→ It is possible that the standard Windows® mouse driver is not installed correctly and that this product is detected as an unknown device by Windows®. This product is usually detected as a USB human interface device. If it is detected as an unknown device, see "Removing an unknown device," and after removing the device from Device Manager, repeat "Step 2 - Installing the Receiver Unit" on the front of this sheet.

→ If you have installed drivers and settings utilities produced by the original manufacturer for a previous mouse, uninstall them first. This product may not operate correctly if a driver made by another company is installed. See the instruction manual that was supplied with your previous mouse for uninstall instructions.

→ It is possible that the driver is conflicting with another driver such as that for a laptop touch pad. To use this product correctly, you must delete the touch pad driver. However, if you delete this driver, you may not be able to use the touch pad or touch pad functions. Contact the PC manufacturer for more details.

■ The wheel moves, but the mouse cursor does not

→ In certain applications that do not support the scrolling function, the mouse cursor will not move when you move the wheel.

Basic specifications

| | |
|--------------------------------|---|
| Product name | Wireless Touch Sensor BlueLED Mouse |
| Article No. | M-TC01DB series |
| OS*1 | Windows® 8 Pro, Windows® 8, Windows® RT *1 In certain applications that do not support the scrolling function, the mouse cursor will not move when you move the wheel. |
| Resolution (dpi) | 1000 dpi |
| Interface | USB |
| Radio frequency | 2.4 GHz bandwidth |
| Radio wave method | GFSK |
| Radio wave outreach | Non-magnetic substance (e.g. wooden desk): Approx. 10 m Magnetic substance (e.g. metal desk): Approx. 3 m * Based on values obtained in ELECOM's test environment and not guaranteed values. |
| Mouse dimensions | 67.6 (W) x 107.9 (D) x 37.8 (H) mm |
| Receiver unit dimensions | 12.0 (W) x 19.0 (D) x 4.6 (H) mm |
| Operating temperature/humidity | 5 to 40°C, 90% RH max. (with no condensation) |
| Storing temperature/humidity | -10 to 60°C, 90% RH max. (with no condensation) |
| Batteries | Use two AA alkaline batteries, AA manganese batteries, or AA nickel hydride rechargeable batteries |
| Operating time | Measure of the operating time when AA Alkaline batteries are used Continuous operating time: Approx. 173 hours Continuous standby time: Approx. 416 days Estimated serviceable time: Approx. 326 days (when the PC is operated for eight hours a day and 5% of the PC operation is assigned to mouse operation) |

Limitation of Liability

- ELECOM Co., Ltd. shall be held in no way liable for any compensation for special damages, consequential damages, indirect damages, punitive damages, or lost profit arising out of the use of this product.
- ELECOM Co., Ltd. makes no guarantees concerning the loss of data, errors, or any other problems that may occur on devices connected to this product.

Disposal of Old Electrical & Electronic Equipment



When you no longer need to use this product and the battery, be sure to dispose of it in accordance with the local ordinances and laws of your area.

ELECOM CO., LTD.

URL : <http://www.elecom.co.jp/global/overseas@elecom.co.jp>

ELECOM Korea Co., Ltd.
5F Suam Bldg. 1358-17, Seocho2-dong, Seocho-gu, Seoul 137-862, Korea
TEL : 1588-9514
FAX : (02) 3472-5533
URL : www.elecom.co.kr
新宜麗客民台(上海)商貿有限公司
上海市徐家匯肇嘉浜路1065甲号飛雕國際大廈704室
電話 : 86-21-33680011
FAX : 86-21-64271706
URL : www.elecom.cn

ELECOM Sales Hong Kong Ltd.
2/F, Block A, 2-8 Watson Road, Causeway Bay, Hong Kong
TEL : (852) 2806-3600
FAX : (852) 2806-3300
e-mail : info@elecom.asia
URL : www.elecom.asia

ELECOM Singapore Pte. Ltd.
33 UBI AVENUE 3 # 03-56. VERTEX SINGAPORE (408868)
TEL : (65) 6347-7747
FAX : (65) 6753-1791

ELECOM India Pvt. Ltd.
408-Deepali Building, 92- Nehru Place, New Delhi-110 019, India
TEL : 011-40574543
e-mail : support@elecom-india.com
URL : <http://www.elecom-india.com/>

ELECOM Europe GmbH
Schulstrasse 53, D-65795 Hattersheim, Germany
Telefon : +49 (0) 6190 88769 - 243
Telefax : +49 (0) 6190 88769 - 111
e-mail : contact@elecom-europe.com
URL : www.elecom-europe.com

Wireless Touch Sensor
BlueLED Mouse
M-TC01DB series
User's Manual
1st edition, November 20, 2012
ELECOM Co., Ltd.

- This manual is copyright of ELECOM Co., Ltd.
- Unauthorised copying and/or reproducing of all or part of this manual is prohibited.
- If you have any comments or questions about this manual, please contact the retailer from whom you purchased the product.
- The specifications and appearance of this product may be changed without prior notice for product improvement purposes.
- ELECOM Co., Ltd. shall bear no responsibility for any and all affects resulting from the use of this product.
- Export or service transaction permission under the Foreign Exchange and Foreign Trade Control Law is required in order to export this product or parts of this product that constitute strategic materials or services.
- Internet Explorer, Windows and the Windows logo are either registered trademarks or trademarks of Microsoft Corporation in the United States and/or other countries.
- Bluetooth® wordmark and logo are trademarks owned by Bluetooth SIG, Inc. and ELECOM has permission to use these trademarks.
- Other business and product names are generally other companies' trademarks or registered trademarks.