

How to change the hardware keyboard settings for Windows/macOS

You will need to change the setting to Japanese (JIS) layout keyboard if it is not recognized as a Japanese (JIS) keyboard when connected. The respective procedures for Windows/macOS are as follows.

For Windows® 10

Change the setting if the connected Japanese 106/109 keyboard is recognized as an English 101/102 keyboard and you are unable to input as printed on the keys.

■ Change “Hardware keyboard layout”

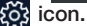
- 1 Click on “Start”  on the lower left of the screen, and click on the “Settings”  icon.

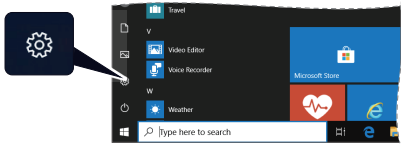

- 2 Click on “Time & Language”.

The “Time & Language” page will appear.

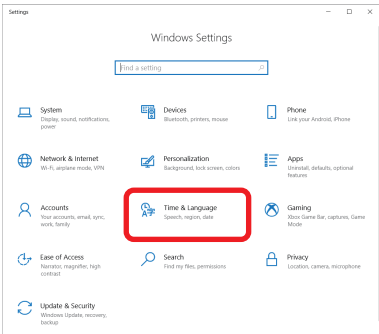

- 3 Click on “Language”.

The “Language” page will appear.

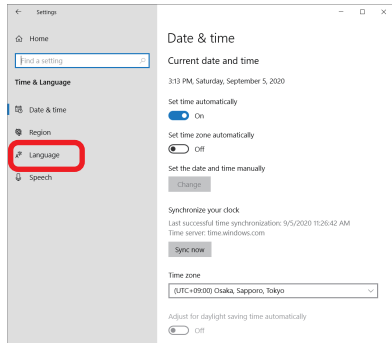

- 4 Select “Japanese” from the list of languages and click on “Options”.

The “Japanese” page will appear.

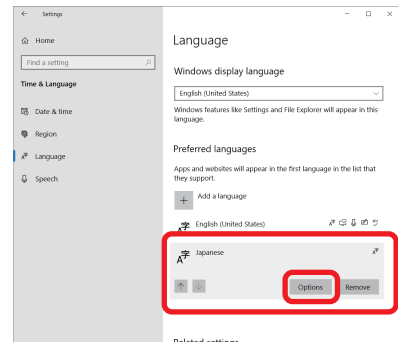

- If “Japanese” is not on the list of languages, click on “+ Add a language” and add “Japanese” from the page.

- 5 Click on “Change layout” under Hardware keyboard layout. The “Change hardware keyboard layout” dialogue should appear.

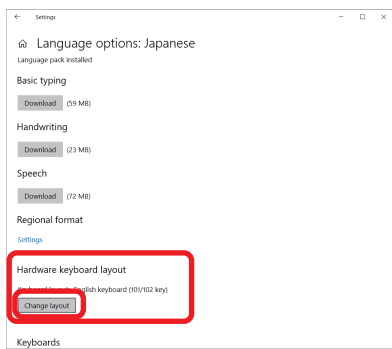

- 6 Select “Japanese keyboard (106/109) key” from the pull down list.

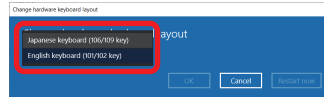

- 7 Click “Restart now”.

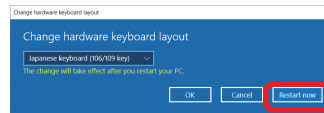

The keyboard layout (key assignment) will be set to “Japanese keyboard (106/109 key)” after restart.

To input IME dependent special characters, follow steps **8** - **10** below to change the input method to “Japanese - Microsoft IME”.

- 8 Follow steps **1** - **3** to open the “Language” page.

- 9 Click on “Choose an input method to always use as default”.

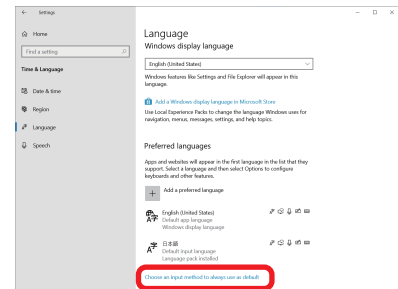

- 10 Change the input method to “Japanese - Microsoft IME”.

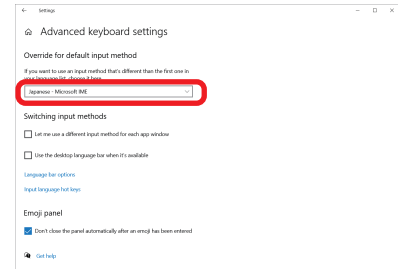

日本語 (JIS) 配列キーボードを接続したときに、日本語キーボードとして認識されない場合に日本語 (JIS) 配列キーボードに設定を変更する必要があります。
日本語版 ユーティリティを以下よりダウンロードして設定を変更することも可能です。
※日本語のみ対応

<https://www2.elecom.co.jp/search/download/list.asp?group=/peripheral/full-keyboard/>

IME依存の特殊文字を入力するには、以下の Change “Hardware keyboard layout”の**3**～**10**の手順に従って、インプットメソッドを「Japanese - Microsoft IME」に変更する必要があります。

■ Update the device driver from the “Device Manager”.

If the input and the printing on the keys do not match up even after the steps above, please try to update the device driver using the following steps.

- 1 Right click on the start menu. Click on “Device Manager”.

- 2 Click on “Keyboard” to expand. Right click on “HID Keyboard Device” and select “Update driver” from the menu. The “Update driver” wizard should appear.

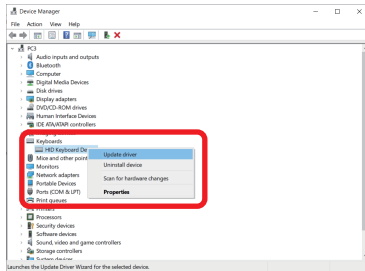

- 3 Click on “Browse my computer for drivers”.

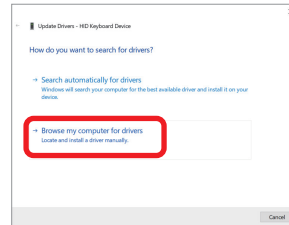

- 4 Click on “Let me pick from a list of available drivers on my computer”.

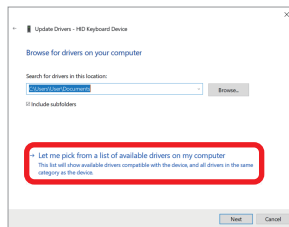

- 5 In the “Select the device driver you want to install for this hardware” page, uncheck “Show compatible hardware”, select “(Standard keyboards)” under Manufacturer, then select “Japanese PS/2 Keyboard (106/109 key)”. Click “Next”.

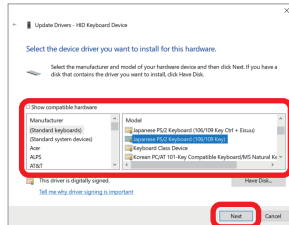

- 6 The “Update Driver Warning” dialogue should appear. Click “Yes”.



- 7 When the device driver update is complete, restart Windows.

- Changes made to the device driver will not be reflected if Windows is not restarted.

- ELECOM CO., LTD. owns the copyright of this manual.
- Unauthorised copying and/or reproducing of all or part of this manual is prohibited.
- If you have any suggestions or doubts about this Manual, please contact the retailer whom you purchased the product from.
- The specifications and appearance of this product may be changed without prior notice for product improvement purposes.
- We shall bear no responsibility for any device failure or malfunction of other devices resulting from the use of this product.
- When exporting this product, check the export regulations for the country of origin.
- Windows and Windows logo are either trademarks or registered trademarks of Microsoft Corporation in the United States and/or other countries.
- macOS is a trademark of Apple inc., registered in the U.S. and other countries.
- Company names, product names, and other names in this manual are either trademarks or registered trademarks.

For macOS

Keyboard types can be selected from “Keyboard Setup Assistant” under “Keyboard” preferences.

Or, when “Keyboard Setup Assistant” starts up when the keyboard is connected, follow the steps below from step **4** to set the keyboard type to “JIS (Japanese)”.

- 1 Click “System Preferences...” under the Apple menu. The System Preferences window will appear.

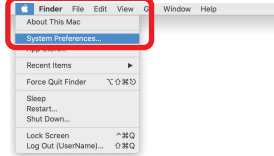

- 2 Click on “Keyboard”. The keyboard preferences window will appear.

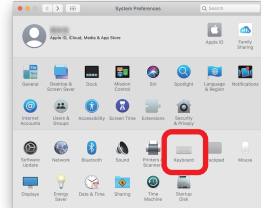

- 3 Click on “Change Keyboard Type...” “Keyboard Setup Assistant” will start up.

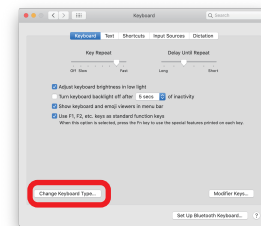

■ “Keyboard Setup Assistant” will start up.

- 4 Click “Continue”.

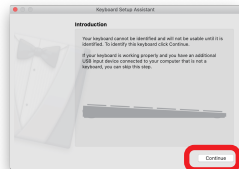

- 5 Press the key on the right of the left Shift key on the connected keyboard.

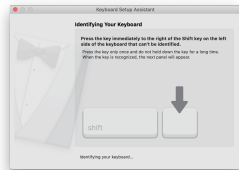

- 6 Press the key on the left of the right Shift key on the connected keyboard.

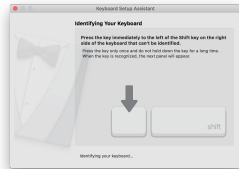

- 7 Select “JIS (Japanese)”. Click “Done”. The connected keyboard will be correctly recognized as a Japanese keyboard.

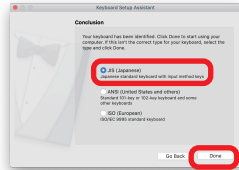

A customer who purchases outside Japan should contact the local retailer in the country of purchase for enquiries. In “ELECOM CO., LTD. (Japan)”, no customer support is available for enquiries about purchases or usage in/from any countries other than Japan. Also, no foreign language other than Japanese is available. Replacements will be made under stipulation of the Elecom warranty, but are not available from outside of Japan.

Keyboard Setup Guide, 2nd edition, January 19, 2021

ELECOM

©2021 ELECOM Co., Ltd. All Rights Reserved.