

## Portable Power Station 700N

## Portable Power Station 700N Manual

DE-P03A series

Compliant Model: DE-P03ABK

ELECOM

Thank you very much for purchasing this product. This manual details the operation method and precautions for the safe handling of the product. Please read this Instruction Manual before use. After reading, keep this manual safe for future reference.

### Package Contents

Verify the package to ensure all contents are present prior to using the product. Every effort has been made to ensure proper packaging, however, in the event any shortage or damage is discovered, contact the retailer where the product was purchased.

Portable battery x 1

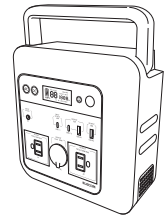

Dedicated AC adapter  
(length of cord approximately  
1.4 m/4.6 ft) x 1

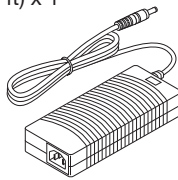

Dedicated power cord  
(length of cord approximately  
1.4 m/4.6 ft) x 1

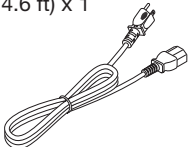

Dedicated auxiliary power outlet adapter  
(length of cord approximately  
1.4 m/4.6 ft) x1

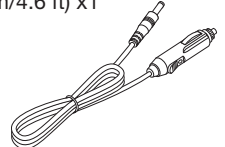

Instruction manual (this document) x 1

\* No USB Type-C® cable or USB Type-C AC charger for charging this product from USB Type-C input/output port 1 are included. Please purchase them separately.

- Please use a USB Type-C and a USB Power Delivery 3.0 60 W and higher USB Type-C AC charger.

### Safety Precautions (Be sure to always follow these precautions)

#### Safety Precautions

- Before using this product, please read these "Safety Precautions" carefully and use this product correctly. Please keep this manual carefully after reading.
- This manual describes the necessary precautions you must take to prevent hurting yourself and others or damaging property.

#### About the icons

- The following icons describe the different degree of harm or damage which may result from incorrect use or failure to observe the precautions.

	<b>WARNING</b>	This icon indicates that if the product is mishandled, the user may be killed or seriously injured* <sup>1</sup> .
	<b>CAUTION</b>	This icon indicates that if the product is mishandled, the user may be injured* <sup>2</sup> or property may be damaged* <sup>3</sup> .

\*1 Serious injuries: refers to those that cause consequences such as blindness, injury, burns (high and low temperatures), electric shock, fractures, and poisoning that require hospitalization or long-term hospital visits for treatment.

\*2 Injury: refers to injuries and burns (high and low temperatures) that do not require hospitalization or long-term hospital visits for treatment, electric shock, etc.

\*3 Property damage: refers to extended damage to homes, household property, livestock, pets and such.

#### Regarding icons

The instructions in this manual and labels on this product use various icons to ensure the safe and correct use of this product and to prevent harm to you and other people as well as damage to property. These icons and their definitions are as follows. Please fully understand this before reading the main text.

	Icon indicating prohibited actions. Specific prohibitions are depicted in or near the image.
	This icon indicates that the instructions must be carried out. Specific prohibitions are depicted in or near the image.
	This icon indicates a warning or a caution (to be careful). Specific prohibitions are depicted in or near the image.

### Names of individual components

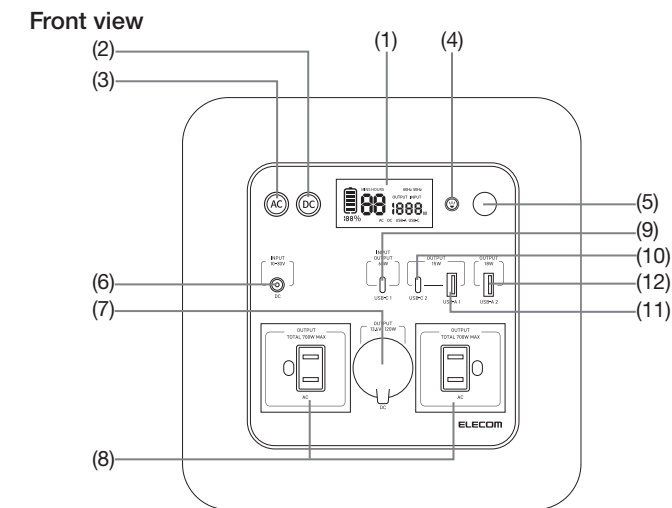

Left view

Right view

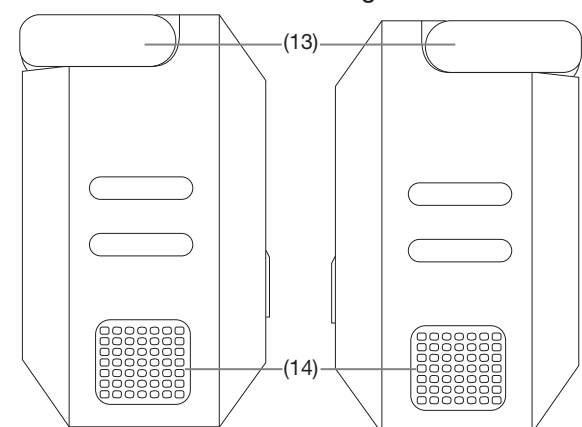

#### (1) LCD display

##### Charging time / Power supply time

If INPUT is on the "Output/Input Display", the time needed to charge this product is displayed, and if OUTPUT is on the "Output/Input Display", the power supply time is displayed.

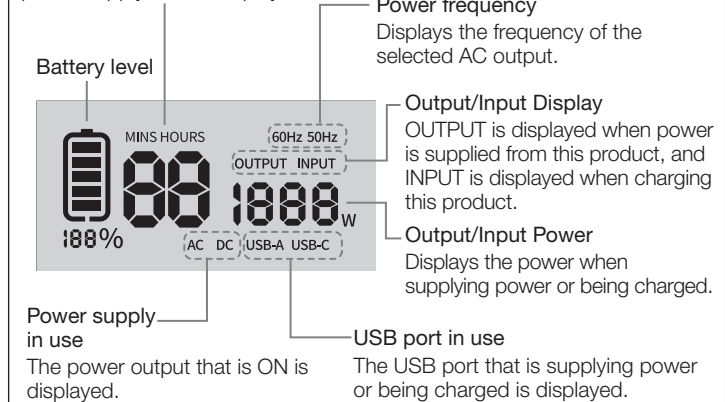

#### (2) DC button

Press and hold for at least 3 seconds to turn on the power supply, DC output, and USB output, and charge the DC-connected device.  
\* Excludes USB Type-C input/output port 1.  
USB Type-C input/output port 1 turns on automatically when a device is connected.

#### (3) AC Button

Press and hold for at least 3 seconds to turn on the power and AC output, and charge the AC-connected device.

#### (4) Light button

Press and hold for at least 3 seconds to turn on the power and turn on the LED light. Press and hold it again for at least 3 seconds to turn off the LED light. Each time you briefly press the light button when it is on, you can switch between three stages: "bright", "dim", and "SOS (blinking)".

	<b>WARNING</b>
	Stop using this product immediately if any of the following abnormalities occur. <ul style="list-style-type: none"><li>• Smoke or odors are emitting from this product</li><li>• Water or foreign objects get inside this product</li><li>• If this product is damaged, deformed, or deteriorated by dropping or cracking</li><li>• If the AC adapter is damaged</li><li>• If the power cord or power plug is damaged</li><li>• If the auxiliary power outlet adapter is damaged</li></ul> Continuing to use the product with such abnormalities may cause overheating, fire, burns, injury, and electric shock. Immediately disconnect the AC adapter from the AC power outlet or disconnect the connected cable or device from this product, and confirm that smoke is no longer emitted before contacting the retailer from which you purchased this product. Doing repairs by yourself is dangerous and should never be done.
	Do not disassemble or modify. Doing so may cause malfunction, overheating, fire, burns, or electric shocks.
	Do not use this product with a power supply voltage other than the one indicated. Doing so may cause malfunction, overheating, fire, burns, or electric shocks. This product can only be used in the United States.
	Do not leave this product near fire, inside a car or on metal, such as the car hood, on a hot day, on asphalt, on sand, such as at a beach, or in other places where the temperature gets high. Doing so may cause malfunction, overheating, fire, cracking, or burns.
	Do not subject this product to strong impact or throw it. Doing so may cause malfunction, overheating, fire, or cracking.
	Do not allow liquid to enter this product or wet it. Doing so may cause malfunction, overheating, fire, burns, or electric shocks.
	Do not touch this product, the power plug, or the connected cable with wet hands. Doing so may cause malfunction, overheating, fire, burns, or electric shocks.
	Do not insert metal objects into the terminals. Doing so may cause malfunction, overheating, fire, burns, or electric shocks.
	If you hear thunder, do not touch the power plug or charge this product. It can cause electric shocks.
	Push the power plug firmly all the way into the AC power outlet. A loose connection may result in overheating, fire, burns, or electric shocks.

	<b>WARNING</b>
	Do not put it in fire. Doing this may cause an explosion or breakage.
	Do not supply power or perform construction to supply power to household products. Doing so may cause malfunction, overheating, fire, burns, or electric shocks.
	Do not forcibly pull or bend the cable, and do not place any heavy objects on it. Also, do not plug or unplug the cable by holding any part other than the connector. Doing so may cause the external cord to be damaged or break, or cause overheating, fire, burns, or electric shock.
	Do not look directly at the LED light when it is emitting light. Doing so may damage your eyes.

	<b>CAUTION</b>
	Do not put anything on it or place it on an unstable surface. Doing so can cause injuries if it falls over or drops.
	Do not cover or wrap the included dedicated AC adapter in cloth or a blanket. The AC adapter heats up during use. Doing so may cause malfunction, overheating, fire, or burns.
	Do not use the included dedicated AC adapter for any devices other than this product. Doing so may cause malfunction, overheating, fire, or burns.
	Leave some space so that the power plug can be easily plugged in and unplugged. Plug the included dedicated AC adapter in a place easily accessible from the AC outlet, and if an abnormality occurs, immediately unplug the power plug from the AC outlet.
	Do not use any power cord other than the supplied dedicated power cord. Do not use the included dedicated AC adapter for any device other than this product. Doing so may cause malfunction, overheating, fire, or burns.
	When not in use for a long time, unplug the included dedicated AC adapter from the AC power outlet. Not doing so can cause malfunction.
	Do not use the portable power supply in abnormally low temperatures or when it is cold. Doing so may damage the battery.

### Charge this product

	<b>CAUTION</b>
	Please fully charge the product before using it for the first time.
	Storing the battery for a long time with low battery power may result in deterioration of performance or inability to charge due to over-discharge. When storing this product for a long time, charge it regularly to about 60% - 80%.
	To prevent your car's battery from running out, charge this product with the engine running.
	After supplying power to the connected devices, the internal temperature of this product may be high, so it may not be possible to charge it immediately. In this case, leave this product in an environment with optional operation temperature (0 °C - 40 °C/32 °F - 104 °F) for a while before charging.

This product can be charged with the included dedicated AC adapter, the dedicated auxiliary power outlet adapter, or a commercially available USB Type-C AC charger.

#### ■ Charging using the dedicated AC adapter or the dedicated auxiliary power outlet adapter

- ① Connect the included dedicated AC adapter or the included dedicated auxiliary power outlet adapter to the DC input port on this product to charge.
- ② Connect the included dedicated AC adapter to an AC power outlet, or connect the included dedicated auxiliary power outlet adapter to the auxiliary power outlet in a car.  
Charging will begin immediately. When charging starts, the LCD display shows the charging time required and the charging power, and the battery level is also displayed in animation. When charging is complete, the battery level indicator light will light up.

Charging using the dedicated AC adapter

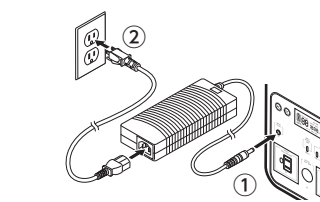

Charging with the dedicated auxiliary power outlet adapter

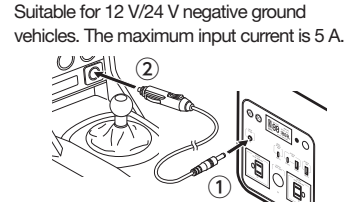

- ③ When the product is fully charged, disconnect the cable by following step ② then ①.  
The power will turn off automatically after about 30 seconds.

### Usage Precautions

- The inner diameter of the auxiliary power outlet of this product is 21 mm/0.83 in. Please use products with cigarette lighter plugs that fit this internal diameter. In addition, do not use this product with cigarette lighters as it is not compatible cigarette lighters.
- This product is not designed to be dustproof or waterproof. Be careful not to get dust, water, or other liquids on this product. Any liquid, such as seawater, rain, water spray, juice, coffee, steam, and sweat, may cause this product to malfunction.
- Do not charge, use, or leave this product in dusty or hot and humid places.
- If this product is submerged in water, leave it in a spacious area with no flammable materials around it for a period of time.
- Do not use this product in places without ventilation. In the event of an abnormality, the internal battery may emit gas.
- For safety reasons, please leave at least 5 cm/2 in. of space around this product when installing it.
- Due to the characteristics of this product, it will become warm when charging or supplying power. Do not place anything around it.
- Before using this product, check that there is no foreign matter such as dust or liquid in the connectors of this device or the device to be connected. Check for the presence of water, especially if the connected waterproof device is wet. Charging when the connector is wet or has foreign matter in it may cause malfunction, overheating, fires, burns, or electric shocks.
- When connecting this product to your device, follow the precautions for charging your device closely.
- Do not use a USB Type-C AC charger or USB Type-C cable that does not support the charging specifications of this product. Doing so may cause malfunction, overheating, fire, or burns.
- During charging or power supply, noise may occur in electronics such as radios, tuners, and TVs. If noise occurs, use this product away from those electronics.
- Do not use if you have a heart pacemaker. Your pacemaker may be affected by this product.
- If this product becomes dirty, wipe it with a soft, dry cloth. If the product is badly soiled, wipe it with a cloth that has been soaked in water or diluted neutral detergent and wrung dry. Do not use substances such as paint thinner or benzene.
- Please keep out of reach of children.
- Do not use as a power source to power life-saving equipment such as medical equipment.



## Supplying power from this product to connected devices

### ① Press and hold the AC button or DC button for at least 3 seconds.

This product is turned on and the LCD screen lights up.

#### When using the DC output or USB output

Press and hold the DC button for at least 3 seconds.

The LCD display will light up and show “DC” and “USB-A”.

\* Excludes USB Type-C input/output port 1.

USB Type-C input/output port 1 turns on automatically when a device is connected.

#### When using AC output

Press and hold the AC button for at least 3 seconds.

The LCD display will light up and show “AC”.

### ② Connect the device that will be powered by this product to the compatible output port, output outlet, or output socket.

\* When connecting the device to this product, make sure to follow the precautions for that device.

#### DC output or USB output

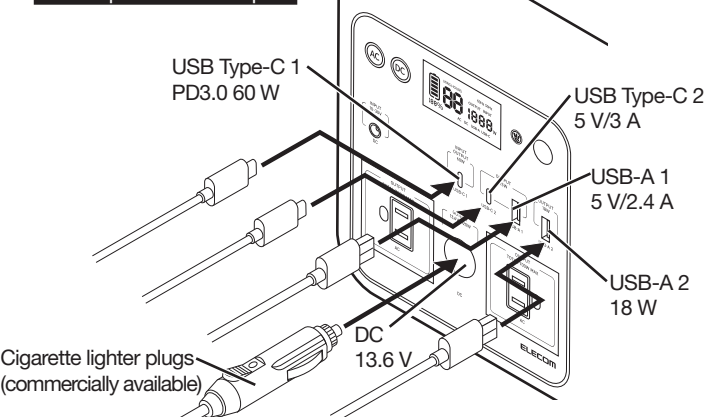

\* To fast charge a connected device using USB Type-C, connect it to USB Type-C input/output port 1 and use a cable that supports USB Power Delivery.

\* To fast charge a device connected using USB-A, connect it to USB-A output port 2 and use a cable that supports 18 W.

## Maintaining and storing this equipment

- Please charge this product to 60% - 80% and turn it off before storing this product for a long time. Please check the battery level once every 6 months during long-term storage.
- Keep the product in a cool, dry, and ventilated place. Keep it away from water, flammable gas, corrosive substances, metal dust, and salt.

### ■ Regarding the recycling of lithium-ion batteries



#### Li-ion20

A lithium-ion battery is built into the product. Lithium-ion batteries are precious resources that can be recycled, so we request for your cooperation in recycling. Follow guidance of local municipal government where you live when disposing of the product.

- Please do not remove the batteries by yourself.
- Do not dispose this product as household waste. The destroyed lithium ion battery inside a garbage truck causes a short-circuit and may lead to a fire or heat generation.

## Troubleshooting

This product cannot be charged.	►	Solution
		Check that the AC adapter or USB Type-C charger is correctly connected.
		Charge within the charging temperature range of this product (0 °C - 40 °C/32 °F - 104 °F).
This product does provide power.	►	If the battery of this product is empty when stored for a long time, its performance may deteriorate or it may not be able to charged up. In this case, do not use as it may overheat or catch fire.
		Solution
This product makes noise.	►	Please check the battery level of this product. Please charge this product if the battery level is low.
		Solution
This product cannot be turned off.	►	Solution
		It is normal to hear a fan noise from the ventilation ports while using this product.
		Check if “AC” or “DC” is shown on the LCD display. If AC or DC is displayed, press and hold the corresponding button for at least 3 seconds to turn off the display.
		If the LED light is on, long press the light button for at least 3 seconds to turn it off. The power will turn off after about 30 seconds.
	►	If a device is connected to USB Type-C input/output port 1, remove the connected device.

#### AC output

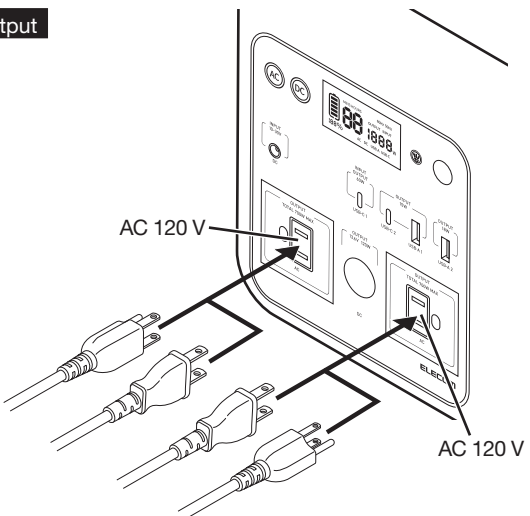

Also compatible with 3P-type AC plugs. Pay attention to the orientation of the grounding pin when plugging into the output outlet.

### ③ The LCD display shows the number of charging hours available and the power being supplied.

#### DC output or USB output

The LCD display shows the number of charging hours available, the power supply, and the USB port that is supplying power.

#### AC output

The LCD display shows the number of charging hours available, the power supply and the frequency of the power supply.

\* Both the DC output and AC output can be used at the same time. However, if the total power consumption of the connected devices exceeds the power supply capacity of this product (maximum 813 W), the power supply automatically stop. Furthermore, even if the power required is less than the supply capacity of this product, the power supply may stop should a large amount of power is required when powering up or turning on a heat source.

## Product specifications

### Output specifications

Output terminal	AC power outlet x 2, auxiliary power outlet x 1, USB Type-C port x 2, USB-A port x 2	
AC power outlet	Rated output voltage	700 W, 2 outlets combined
	Maximum instantaneous output power	1300 W (10 s), 1301 W (1 s)
	Rated output voltage	120 V
	Rated output current	5.83 A, 2 outlets combined
	Rated power frequency	60 Hz
Auxiliary power outlet	Rated output voltage	120 W
	Rated output voltage	13.6 V
	Rated output current	8.8 A
USB Type-C port 1	Supports fast charging	USB Power Delivery 3.0 60 W
	Rated output voltage	5 V, 9 V, 12 V, 15 V, 20 V
	Rated output current	5 V / 3 A, 9 V / 3 A, 12 V / 3 A, 15 V / 3 A, 20 V / 3 A
USB Type-C port 2	Rated output voltage	15 W
	Rated output voltage	5 V
	Rated output current	3 A
USB-A port 1	Rated output voltage	12 W
	Rated output voltage	5 V
	Rated output current	2.4 A
USB Type-C port 2 + USB-A port 1	Combined power output	15 W
	Combined current output	5 V / 3 A
USB-A port 2	Supports fast charging	18 W
	Rated output voltage	5 V, 9 V, 12 V
	Rated output current	5 V / 3 A, 9 V / 2 A, 12 V / 1.5 A
Maximum combined power output		813 W

### ④ After using, press and hold the button corresponding to the output for at least 3 seconds.

If “DC” is shown on the LCD display, press and hold the DC button for at least 3 seconds. If “AC” is displayed, press and hold the AC button for at least 3 seconds.

The “DC” or “AC” display will turn off and the output will stop. The power will turn off when both the DC and AC outputs stop. Remove the cable after that.

\* When the LED light is on, the power will not turn off even if the DC output and AC output are stopped. Press and hold the light button for at least 3 seconds to turn off the LED light. The power will turn off after about 30 seconds.

### ■ Supplying power using only USB Type-C input/output port 1

To supply power via the USB Type-C port 1, connect the device to be powered and this product using a USB Type-C cable. This product will turn on and starts charging automatically.

\* Remove the cable after charging is complete. The power will turn off automatically.

### ■ How to check the battery level

When the LCD display is off, press and hold the DC button or AC button for at least 3 seconds to turn on the power, and the LCD display will show the remaining battery level.

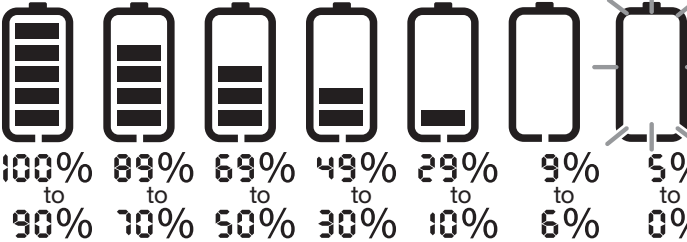

\* When the battery level is 5% or less, the frame of the battery mark will start blinking.

\* To turn off the display, press and hold the DC button or AC button for at least 3 seconds to stop all output and turn off the power.

\* When the battery level of this product reaches 0%, the power supply will automatically stop. In this case, stop supplying power to the connected device and charge this product.

### ■ Switching the frequency of the AC output

With the AC output on, press and hold the DC button and the AC button at the same time for 3 seconds.

Each press changes the frequency (50 Hz/60 Hz).

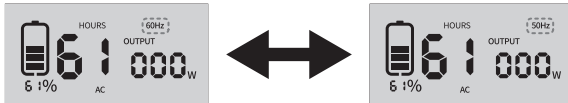

### ■ Turning on the LED light

Press and hold the light button for at least 3 seconds to turn on the LED light.

When the LED light is on, you can briefly pressing the light button to switch between the brightness levels: bright, dim, and SOS (blinking).

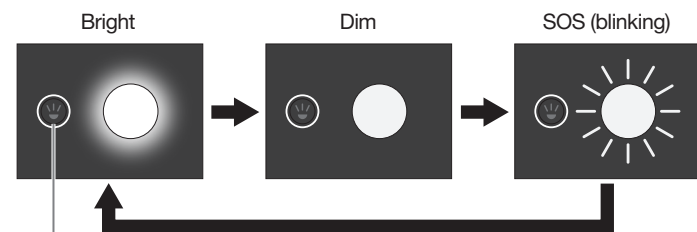

Light button

When the LED light is on, press and hold the light button for at least 3 seconds to turn off the LED light.

\* If the light is turned off while the DC output or AC output is off, this device will turn off after around 30 seconds.

## Regarding error indication

When this product malfunctions, the following will be shown on the LCD display: Please refer to “Possible causes and solutions”.

Display	Problem	Possible causes and solutions
	Overvoltage (charging) protection	The voltage of the power supply from the DC input port is greater than or equal to the rated voltage. Disconnect the AC adapter and other parts from the DC input port and check the status of the input device. * When this protection occurs during charging from USB Type-C input/output port 1, the LCD display will turn off. Disconnect the USB Type-C AC charger from USB Type-C input/output port 1 and check the status.
	Overpower protection	The voltage of the power supply from the DC input port is less than or equal to the rated voltage. Disconnect the AC adapter and other parts from the DC input port and check the status of the input device. * When this protection occurs during charging from USB Type-C input/output port 1, the LCD display will turn off. Disconnect the USB Type-C AC charger from USB Type-C input/output port 1 and check the status.
	Undervoltage (charging) protection	The internal parts are hot. Cool down this product before charging. Also, make sure that the ventilation ports are not obstructed.
	High-temperature charging protection	The internal parts are cold. Warm up this product before charging.
	Low-temperature charging protection	The internal parts are hot. Cool down this product before discharge. Also, make sure that the ventilation ports are not obstructed.
	High-temperature discharge protection	

Display	Problem	Possible causes and solutions
	Low-temperature discharge protection	The internal parts are cold. Warm up this product before discharge.
	Overpower protection	The overall output power from this product exceeds the rating. Disconnect the connected device from this product. Press and hold the AC button or DC button for at least 3 seconds to restore.
	Overcurrent protection	The AC output outlet on this product is overloaded or short-circuited. Disconnect the connected device from this product. Press and hold the AC button for at least 3 seconds to restore.
	Overcurrent protection Short-circuit protection	USB Type-C input/output port 1 on this product is overloaded or short-circuited. Disconnect the connected device from this product.
	Overcurrent protection Short-circuit protection	The auxiliary power outlet on this product is overloaded or short-circuited. Disconnect the connected device from this product. Press and hold the DC button for at least 3 seconds to restore.
	Overcurrent protection Short-circuit protection	USB Type-C output port 2, USB-A output port 1, and/or USB-A output port 2 on this product are overloaded or short-circuited. Disconnect the connected device from this product. Press and hold the DC button for at least 3 seconds to restore.

### Compliance status

[www.elecom.co.jp/global/certification/](http://www.elecom.co.jp/global/certification/)

This device complies with Part 15 of the FCC Rules. Operation is subject to the following two conditions: (1) this device may not cause harmful interference, and (2) this device must accept any interference received, including interference that may cause undesired operation.  
In order to make improvements to this product, the design and specifications are subject to change without prior notice.

**Responsible party**  
ELECOM USA, Inc.  
2211 Michelson Dr. Suite 900,  
Irvine, CA 92612 USA  
elecomusa.com

Trademark and name of the manufacturer:

**ELECOM CO., LTD.**

Fushimimachi 4-1-1, Chuo-ku, Osaka City  
[www.elecom.co.jp/global/](http://www.elecom.co.jp/global/)

-ELECOM CO., LTD. owns the copyright of this manual.  
-Unauthorised copying and/or reproducing of all or part of this manual is prohibited.  
-If you have any suggestions or doubts about this manual, please contact your dealer.  
-The images are for illustration purposes only and may differ from your actual product.  
-The specifications and appearance of this product may be changed without prior notice for product improvement purposes.  
-We shall bear no responsibility for any device failure or malfunction of other devices resulting from the use of this product.  
-When exporting this product, check the export regulations for the country of origin.  
-USB Type-C® and USB-C® are registered trademarks of USB Implementers Forum.  
-The trademark “iPhone” is used with a license from APPLE INC., LTD.  
-The company and product names on the packaging and the manual are, in general, trademarks or registered trademarks of their respective companies.  
-In order to make improvements to this product and for improved safety, the colours and specifications are subject to change without prior notice.

### Global Support



A customer who purchases outside Japan should contact the local retailer in the country of purchase for enquiries.  
In “ELECOM CO., LTD. (Japan)”, no customer support is available for enquiries about purchases or usage in/from any countries other than Japan. Also, no language other than Japanese is available. Replacements will be made under stipulation of the Elecom warranty.

Portable Power Station  
Manual, Safety precautions, and Compliance with regulations  
1st edition, April 12, 2024

**ELECOM**

©2024 ELECOM Co., Ltd. All Rights Reserved.