

Shutter Button Connection Method

■ Structure of shutter button

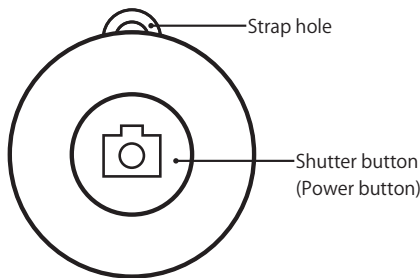

About the LED lights

- Green LED light is lit for 3 seconds
..... Reconnection mode
- Green LED light blinks for 60 seconds
..... Pairing mode
- Green LED light is lit for 1 second
..... → Light is off
..... Pairing completed
- Red LED light blinks slowly
..... Battery replacement guide

Battery replacement method

- ① Open the lid with a coin, or a similar flat-shaped object, and insert the battery.
* Insert so that the positive (+) end of the battery faces upward.
- ② Close the lid tightly with a coin, or a similar flat-shaped object.

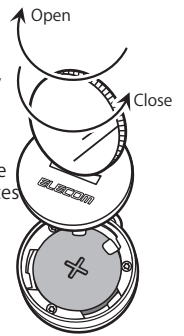

* These illustrations are for illustrative purposes only.

■ Connection method

- 1** Turn on the Bluetooth on your terminal device.

* For settings on the terminal device side, check the instruction manual of the terminal device you are using.

- 2** Press and hold the shutter button on the remote control of this product for about 1 second to turn on the power. (Pairing mode)

- 3** Please select the device name "BTselfie E" displayed on the terminal device.

- 4** When "Connected" is displayed on the terminal device, the connection has been completed.

* If you cannot connect within 60 seconds the power will turn off automatically.

- * If you cannot connect with the method indicated on the left, try again using the Connection Method

2

- To turn off the power Press and hold the shutter button for 3 seconds.
* If there is no operation for more than 3 minutes in the connected state, the power will turn off automatically.
- Reconnection After turning on the power, in 3 seconds it enters reconnection mode and automatically reconnects the smartphone that was connected the previous time.

■ Troubleshooting

■ Does not turn on

It is possible that the remaining capacity of the battery is gone. Replace the battery.

When the remaining battery level becomes low, the red LED light will blink slowly. Upon confirming this state, replace with a new, unused battery as soon as possible.

■ Cannot be paired

- Delete (or cancel) the registration information of this product from the smartphone and try to pair again.
- Make sure that the Bluetooth function of the connected device is in a state that allows pairing. In general, it is necessary to enable the function through the settings on the smartphone side. Please check the settings of the smartphone to be connected.
- The procedure for opening the pairing mode differs depending on the smartphone to be connected. For smartphone operation procedures, also refer to the instruction manual of your terminal device.
- If your smartphone cannot successfully search for Bluetooth devices, try again after rebooting it.
- Suddenly you are no longer able to reconnect despite always having been able to do so

- Depending on your smartphone, registration information may be lost when it repeatedly tries to reconnect, and so you may not be able to reconnect automatically. Restart your smartphone and turn the power on the Bluetooth product off and on again. Also, delete the connection information for the product on the smartphone side and try pairing again.

📶 Precautions regarding radio waves

- The frequency band this product uses is also used by on-premise radio stations (requiring licensing) used for mobile identification performed in the production lines for industrial (such as microwaves), scientific, and medical equipment, and by specified low-power radio stations (not requiring licensing).
- Before using this product, confirm that no mobile radio identification station for mobile identification or specified low power radio station is being operated nearby.
- In the rare event that radio wave interference occurs from this product to a local radio station for mobile identification, stop radio wave emission promptly and contact the Elecom General Information Centre to consult about necessary countermeasures (e.g., setting up partitions, etc.).
- In addition, contact the Elecom General Information Centre if any trouble such as radio wave interference occur from this product to specified low power radio station for mobile identification.
- Do not use this product in places where radio wave usage is prohibited, such as hospitals. Radio waves from this product may affect electronic equipment and medical devices (e.g., pacemakers).
- Because of the risk of interference to the safe operation of aircraft, use of this product in an aircraft is prohibited by aviation laws. Before boarding an aircraft, check that the power of this product is turned off and do not use at any time after boarding.
- Due to the characteristics of using radio waves, this product may cause radio interference with equipment that uses other radio waves under certain conditions.



Safety Precautions

- Never disassemble or modify this product. Since this product is specified radio equipment that has undergone construction design certification, it is prohibited by law to disassemble or modify it. Also, products disassembled or modified are no longer subject to warranty.
- Please use and store this product out of reach of children. Since this product contains batteries and small parts, there is a danger of suffocation etc. if put in the mouth.
- When not using this product for an extended amount of time, store with the battery removed. The battery may leak or cause malfunction.
- This product is not waterproof. Use and store in a place not subject to moisture such as water.
- We cannot assume any responsibility for incidental guarantees surrounding the use of this product for damages such as malfunction of connected equipment, breakage or loss of stored data, or opportunity loss in making telephone calls, etc.

In "ELECOM CO., LTD. (Japan)", no customer support is available to inquiries about purchases or usage in/from any other countries than Japan. No foreign languages other than Japanese is also available. Replacement will be made under stipulation of the Elecom warranty, but not available from outside of Japan. A customer who purchases outside Japan will contact for inquiries the local retailer in the country of purchase.

* The specifications and appearance of this product may be changed without prior notice for product improvement purposes.

* The pictures and illustrations shown on packaging are for illustrative purposes only. Be aware that there may be differences between the pictures/illustrations and the actual product.

* Company names, product names, and other names in this manual are either trademarks or registered trademarks.

* iPhone is a trademark of Apple Inc.

* The Bluetooth® word mark and logos are registered trademarks owned by Bluetooth SIG, Inc. and any use of such marks by ELECOM CO., LTD. is under license.